

PEDV-S

Seismic Rated Dual Duct Terminal Unit

Pneumatic Control, Pressure Independent, without Integral Mixer/Attenuator

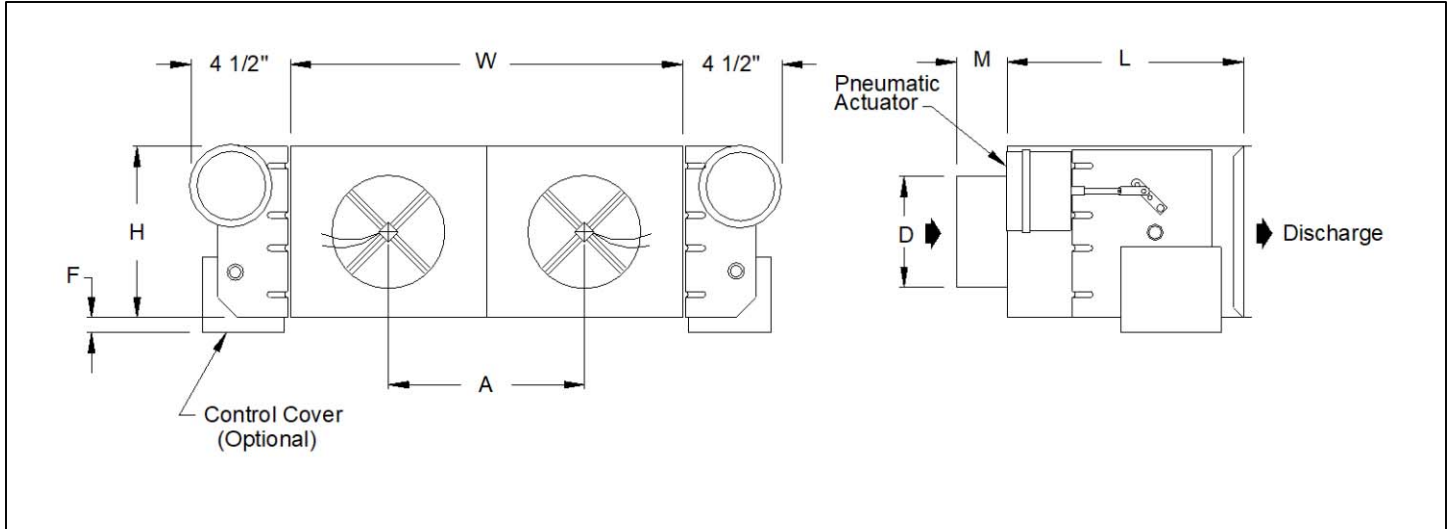

Inlet Size	CFM Range	A	D	F	H	L	M	W
4	0-225	12 1/8	3 7/8	2 1/8	8	15 1/2	5 3/8	24 1/8
5	0-350	12 1/8	4 7/8	2 1/8	8	15 1/2	5 3/8	24 1/8
6	0-500	12 1/8	5 7/8	2 1/8	8	15 1/2	3 3/8	24 1/8
7	0-650	12 1/8	6 7/8	1 1/8	10	15 1/2	3 3/8	24 1/8
8	0-900	12 1/8	7 7/8	1 1/8	10	15 1/2	3 3/8	24 1/8
9	0-1050	14 1/8	8 7/8	-	12 1/2	15 1/2	3 3/8	28 1/8
10	0-1400	14 1/8	9 7/8	-	12 1/2	15 1/2	3 3/8	28 1/8
12	0-2000	16 1/8	11 7/8	-	15	15 1/2	3 3/8	32 1/8
14	0-3000	20 1/8	13 7/8	-	17 1/2	15 1/2	3 3/8	40 1/8
16	0-4000	24 1/8	15 7/8	-	18	15 1/2	3 3/8	48 1/8

Accessories (Optional)

Check if provided.

- | | | |
|---|---|---|
| <input type="checkbox"/> Titus II Velocity Controller | <input type="checkbox"/> 1/2" EcoShield Liner | <input type="checkbox"/> 1" EcoShield Liner (Foil Face) |
| <input type="checkbox"/> Protective Metal Control Cover | <input type="checkbox"/> 1/2" EcoShield Liner (Foil Face) | <input type="checkbox"/> 1" Fibre Free Liner |
| <input type="checkbox"/> Fibre Free Liner | <input type="checkbox"/> 1" Fiberglass Liner | <input type="checkbox"/> SteriLoc Liner |
| <input type="checkbox"/> 1/2" Fibre Free Liner | <input type="checkbox"/> 1" EcoShield Liner | <input type="checkbox"/> Hanger Brackets |

General Description

- Heavy gauge steel housing. Mechanically sealed and gasketed, leak resistant construction. Less than 2% of nominal cfm at 1.5" sp wg.
- Dual density internal insulation, treated to resist air erosion. Meets requirements of NFPA 90A and UL 181.
- Multipoint center averaging inlet velocity sensor.
- Units equipped with the Titus II velocity controller can either be direct acting or reverse acting, with the damper either normally open or normally closed. Controller maintains constant span and start point. (Span and start point are adjustable.)
- Gauge tees for cfm measurement.
- Choice of right hand or left hand cold duct location. Right hand is standard.
- Rectangular discharge opening is designed for slip and drive cleat duct connection.
- OSHPD Seismic Certification: OSP-0352-10